

Modified Sled Kite

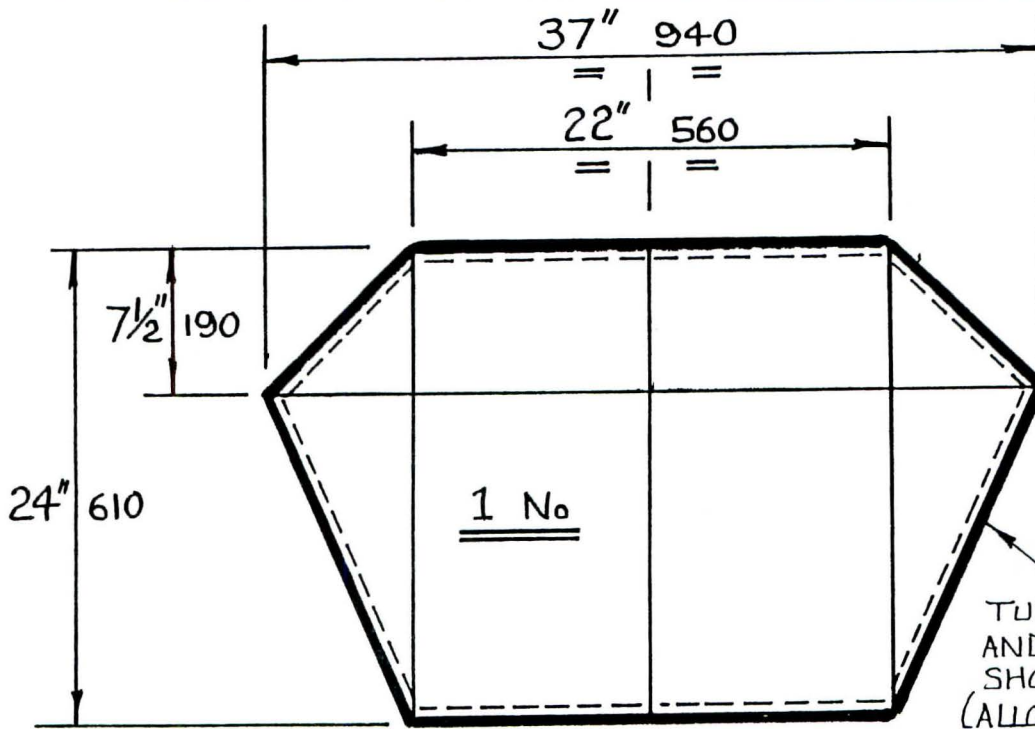

TURN OVER EDGES AND STITCH WHERE SHOWN.
(ALLOW EXTRA MAT:.)

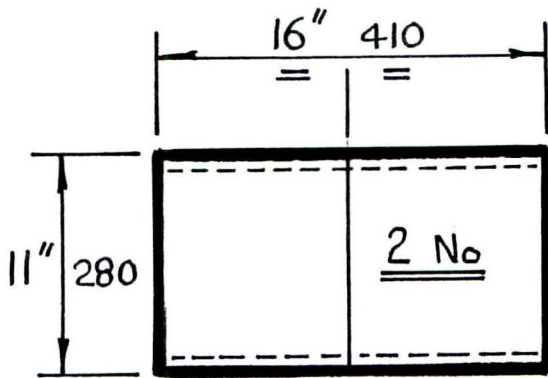

STITCH DOUBLE ROW TO FORM POCKET FOR RODS.

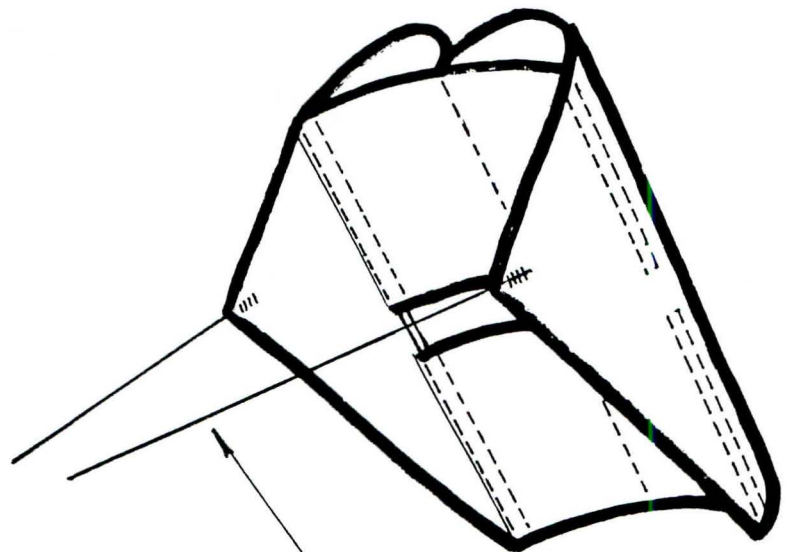

BRIDAL LINES 48" 1220 LONG

The modified sled illustrated here will fly in a wide range of winds and is virtually indestructible. I have made 1ft, 3ft and 4ft versions and all fly well. The 2ft is convenient and is suited to strong winds which I tend to prefer to fly in.

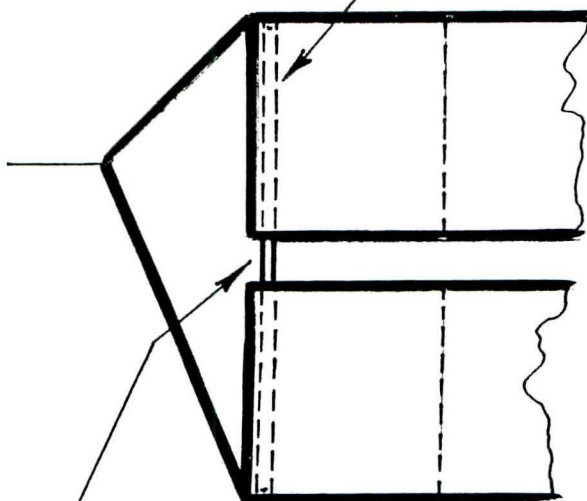

3mm GLASS FIBRE ROD (2 No)

Tony Taylor, 10/99

Modified Sled Kite

Additional Wings

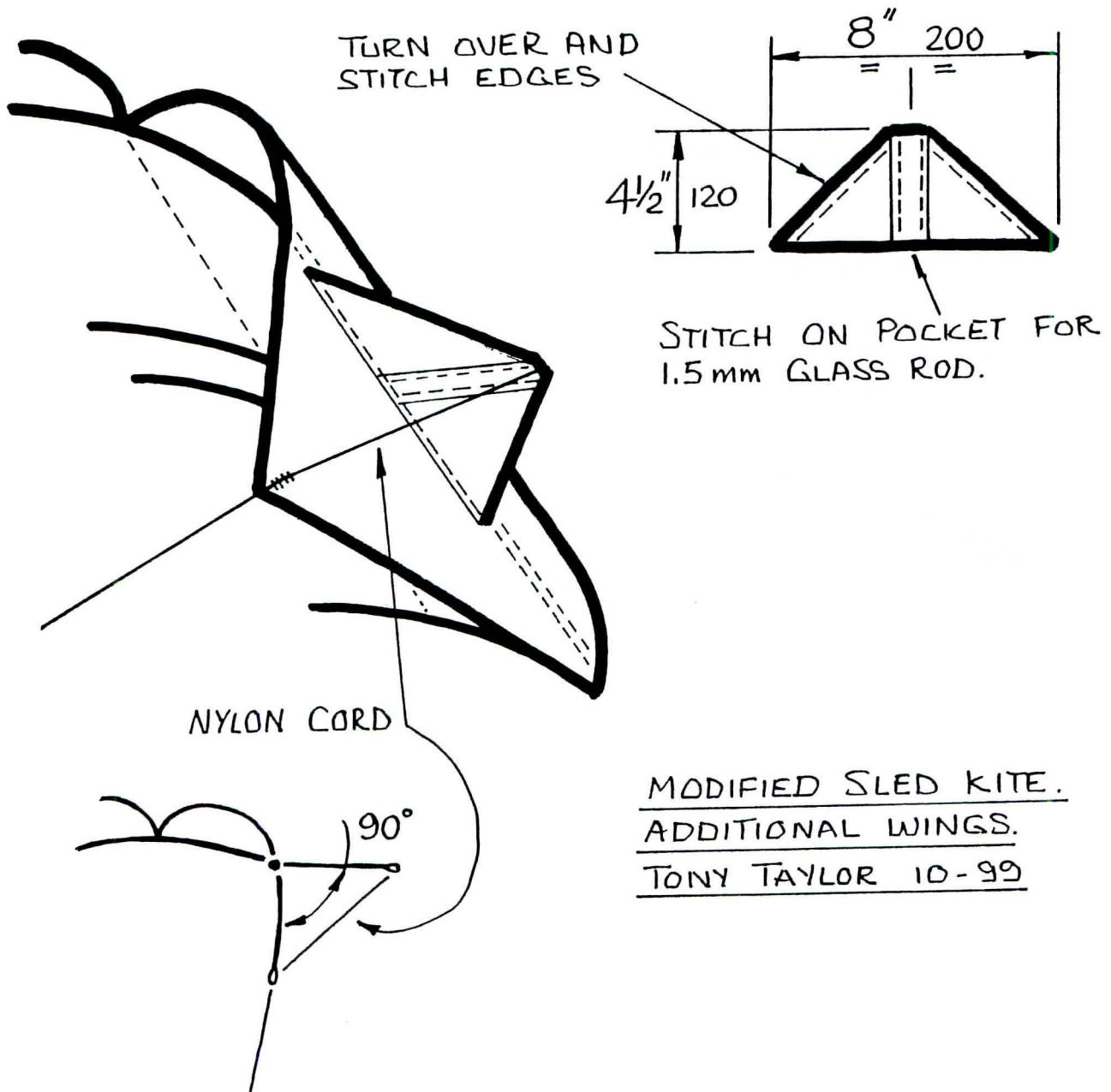

For improved stability in strong winds for the 2ft sled kite try the addition of a small wing stitched to each side, stiffen with a piece of 1.5mm glass fibre rod and held in place with a nylon cord from the bridle point.

Tony Taylor.